

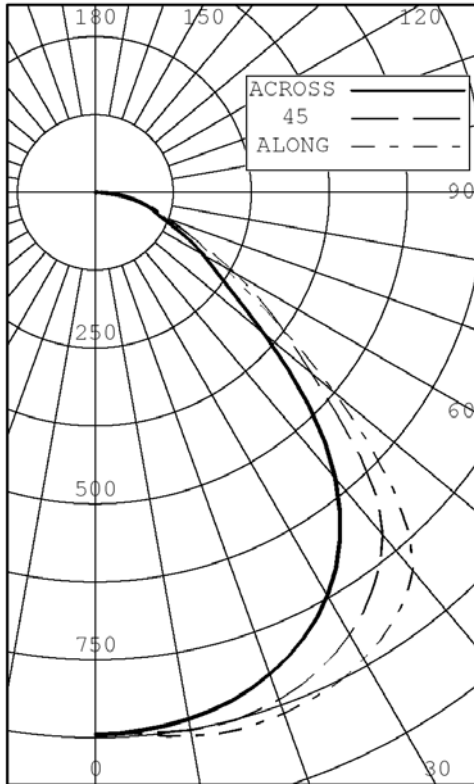

INDEPENDENT TEST LABORATORY REPORT No. 27568

ESCO - 2' X 2' LPS LUMINAIRE
WITH WHITE INTERIOR AND PRISMATIC FLAT PLASTIC LENS
ONE OSRAM 35 WATT LPS LAMP, CAT# 35W SOX. LUMEN RATING = 4800 LMS.
LAMP OPERATING 35.0 WATTS



INTENSITY (CANDLEPOWER) SUMMARY						OUTPUT LUMENS
ANGLE	ALONG	22.5	45	67.5	ACROSS	
0	870	870	870	870	870	
5	873	872	871	869	867	85
10	886	884	876	866	859	
15	892	888	876	857	845	246
20	889	883	865	840	821	
25	880	872	846	813	790	387
30	863	852	817	769	745	
35	836	822	775	709	683	478
40	791	776	716	634	598	
45	675	665	601	530	484	451
50	501	508	452	401	354	
55	339	354	350	286	254	292
60	235	237	258	206	200	
65	174	168	172	157	150	167
70	127	128	121	117	109	
75	96	97	94	90	88	98
80	68	66	63	61	61	
85	33	31	28	28	29	32
90	0	0	0	0	0	

ZONAL LUMENS AND PERCENTAGES

ZONE	LUMENS	% LAMP	% LUMINAIRE
0-30	718	14.96	32.13
0-40	1196	24.91	53.49
0-60	1938	40.38	86.72
0-90	2235	46.56	100.00
40-90	1039	21.65	46.51
60-90	297	6.18	13.28
90-180	0	0.00	0.00
0-180	2235	46.56	100.00

** EFFICIENCY: 46.6% **

LUMINOUS LENGTH: 21.000 INS
WIDTH: 21.000 INS

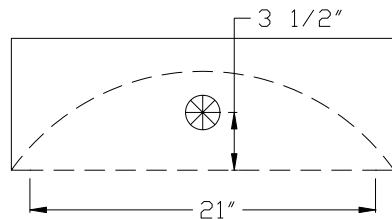

LUMINANCE SUMMARY CD./SQ.M.

ANGLE	ALONG	45	ACROSS
45	3357	2996	2413
55	2078	2151	1565
65	1449	1436	1251
75	1302	1279	1193
85	1329	1129	1186

S/MH: 1.3

SC (ALONG): 1.5, SC (ACROSS): 1.3

CERTIFIED BY:

James E. Walker III

DATE:
AUG 27, 2010

PREPARED FOR:
ESCO LIGHTING INC
CHICAGO, IL

TESTED IN ACCORDANCE WITH IES PROCEDURES.

LIGHTING SCIENCES, INC.
 7826 E. EVANS RD.
 SCOTTSDALE, AZ, USA 85260

INDEPENDENT TEST LABORATORY REPORT No. 27568

ESCO - 2' X 2' LPS LUMINAIRE
 WITH WHITE INTERIOR AND PRISMATIC FLAT PLASTIC LENS
 ONE OSRAM 35 WATT LPS LAMP, CAT# 35W SOX. LUMEN RATING = 4800 LMS.
 LAMP OPERATING 35.0 WATTS

INTENSITY (CANDLEPOWER) DATA
 IN 2.5 DEGREE STEPS

ANGLE	PLANE						OUTPUT LUMENS
	ALONG	22.5	45	67.5	ACROSS	AVERAGE	
0.0	870	870	870	870	870	870	
2.5	869	870	871	872	870	871	
5.0	873	872	871	869	867	870	85
7.5	880	878	874	868	863	873	
10.0	886	884	876	866	859	875	
12.5	891	888	877	863	853	875	
15.0	892	888	876	857	845	872	246
17.5	891	886	871	850	834	867	
20.0	889	883	865	840	821	861	
22.5	885	878	857	829	807	852	
25.0	880	872	846	813	790	841	387
27.5	873	863	833	793	769	828	
30.0	863	852	817	769	745	811	
32.5	851	838	798	741	717	790	
35.0	836	822	775	709	683	767	478
37.5	817	803	750	674	643	739	
40.0	791	776	716	634	598	705	
42.5	746	732	670	587	545	659	
45.0	675	665	601	530	484	594	451
47.5	592	588	522	466	418	520	
50.0	501	508	452	401	354	447	
52.5	415	428	396	339	298	380	
55.0	339	354	350	286	254	322	292
57.5	279	290	305	240	224	272	
60.0	235	237	258	206	200	230	
62.5	202	198	212	180	176	194	
65.0	174	168	172	157	150	165	167
67.5	148	146	142	136	126	140	
70.0	127	128	121	117	109	121	
72.5	110	112	106	102	98	106	
75.0	96	97	94	90	88	93	98
77.5	83	83	80	78	76	80	
80.0	68	66	63	61	61	64	
82.5	52	49	45	45	45	47	
85.0	33	31	28	28	29	29	32
87.5	13	12	10	10	11	11	
90.0	0	0	0	0	0	0	

LIGHTING SCIENCES, INC.
7826 E. EVANS RD.
SCOTTSDALE, AZ, USA 85260

INDEPENDENT TEST LABORATORY REPORT No. 27568

ESCO - 2' X 2' LPS LUMINAIRE
WITH WHITE INTERIOR AND PRISMATIC FLAT PLASTIC LENS
ONE OSRAM 35 WATT LPS LAMP, CAT# 35W SOX. LUMEN RATING = 4800 LMS.
LAMP OPERATING 35.0 WATTS

AVERAGE LUMINANCE DATA

CD./SQ.M (FOOTLAMBERTS)

ANGLE	ALONG	22.5	45	67.5	ACROSS
0	3059 (892)	3059 (892)	3059 (892)	3059 (892)	3059 (892)
30	3502 (1022)	3468 (1012)	3324 (970)	3129 (913)	3023 (882)
40	3630 (1059)	3569 (1041)	3288 (959)	2915 (850)	2742 (800)
45	3357 (979)	3310 (966)	2996 (874)	2642 (771)	2413 (704)
50	2741 (800)	2788 (813)	2470 (720)	2199 (642)	1933 (564)
55	2078 (606)	2171 (633)	2151 (627)	1757 (513)	1565 (456)
60	1649 (481)	1674 (488)	1816 (530)	1452 (423)	1404 (409)
65	1449 (422)	1399 (408)	1436 (419)	1313 (383)	1251 (365)
70	1300 (379)	1321 (385)	1247 (364)	1204 (351)	1123 (327)
75	1302 (380)	1325 (386)	1279 (373)	1229 (358)	1193 (348)
80	1383 (403)	1350 (394)	1269 (370)	1244 (363)	1236 (360)
85	1329 (388)	1234 (360)	1129 (329)	1120 (327)	1186 (346)

LIGHTING SCIENCES, INC.
 7826 E. EVANS RD.
 SCOTTSDALE, AZ, USA 85260

INDEPENDENT TEST LABORATORY REPORT No. 27568

ESCO - 2' X 2' LPS LUMINAIRE
 WITH WHITE INTERIOR AND PRISMATIC FLAT PLASTIC LENS
 ONE OSRAM 35 WATT LPS LAMP, CAT# 35W SOX. LUMEN RATING = 4800 LMS.
 LAMP OPERATING 35.0 WATTS

COEFFICIENTS OF UTILIZATION

ZONAL CAVITY METHOD

EFFECTIVE FLOOR CAVITY REFLECTANCE = .20

CC WALL	90				80				70				50				30				10				0	
	70	50	30	10	70	50	30	10	70	50	30	10	50	30	10	50	30	10	50	30	10	50	30	10	0	
RCR	0	0.570	.570	.570	.57	0.550	.550	.550	.55	0.540	.540	.540	.54	0.520	.520	.52	0.500	.500	.50	0.480	.480	.48	0.47			
1	0.530	.510	.490	.47	0.520	.500	.480	.47	0.500	.490	.470	.46	0.470	.450	.44	0.450	.440	.43	0.430	.420	.42	0.41				
2	0.490	.460	.430	.40	0.480	.450	.420	.40	0.470	.440	.410	.39	0.420	.400	.38	0.410	.390	.38	0.390	.380	.37	0.36				
3	0.450	.410	.370	.35	0.440	.400	.370	.34	0.430	.390	.360	.34	0.380	.360	.33	0.370	.350	.33	0.360	.340	.32	0.31				
4	0.420	.370	.330	.30	0.410	.360	.330	.30	0.400	.360	.330	.30	0.350	.320	.30	0.340	.310	.29	0.330	.310	.29	0.28				
5	0.390	.330	.290	.27	0.380	.330	.290	.26	0.370	.320	.290	.26	0.310	.280	.26	0.310	.280	.26	0.300	.270	.26	0.25				
6	0.360	.300	.260	.24	0.350	.300	.260	.23	0.340	.290	.260	.23	0.280	.250	.23	0.280	.250	.23	0.270	.250	.23	0.22				
7	0.330	.270	.230	.21	0.320	.270	.230	.21	0.320	.260	.230	.20	0.260	.220	.20	0.250	.220	.20	0.240	.220	.20	0.19				
8	0.310	.250	.210	.18	0.300	.240	.210	.18	0.300	.240	.200	.18	0.230	.200	.18	0.230	.200	.18	0.220	.200	.18	0.17				
9	0.290	.220	.190	.16	0.280	.220	.180	.16	0.270	.220	.180	.16	0.210	.180	.16	0.210	.180	.16	0.200	.180	.16	0.15				
10	0.260	.200	.160	.14	0.260	.200	.160	.14	0.250	.200	.160	.14	0.190	.160	.14	0.190	.160	.14	0.190	.160	.14	0.13				

LUMINAIRE INPUT WATTS 35.0

LABORATORY RESULTS MAY NOT BE REPRESENTATIVE OF FIELD PERFORMANCE.
 BALLAST AND FIELD FACTORS HAVE NOT BEEN APPLIED.

TEST DISTANCE EXCEEDS FIVE TIMES THE GREATEST
 LUMINOUS OPENING OF LUMINAIRE.